

APPROVED BY  
 SOUTH CAROLINA DEPARTMENT OF HEALTH  
 AND ENVIRONMENTAL CONTROL  
 DIVISION OF MINING & SOLID WASTE MGT

BY: [Signature], Section Mgr

TITLE: SM-2170-1V2 Modification

DATE APPROVED: 12/2/2021

PERMIT NUMBER: I-002170

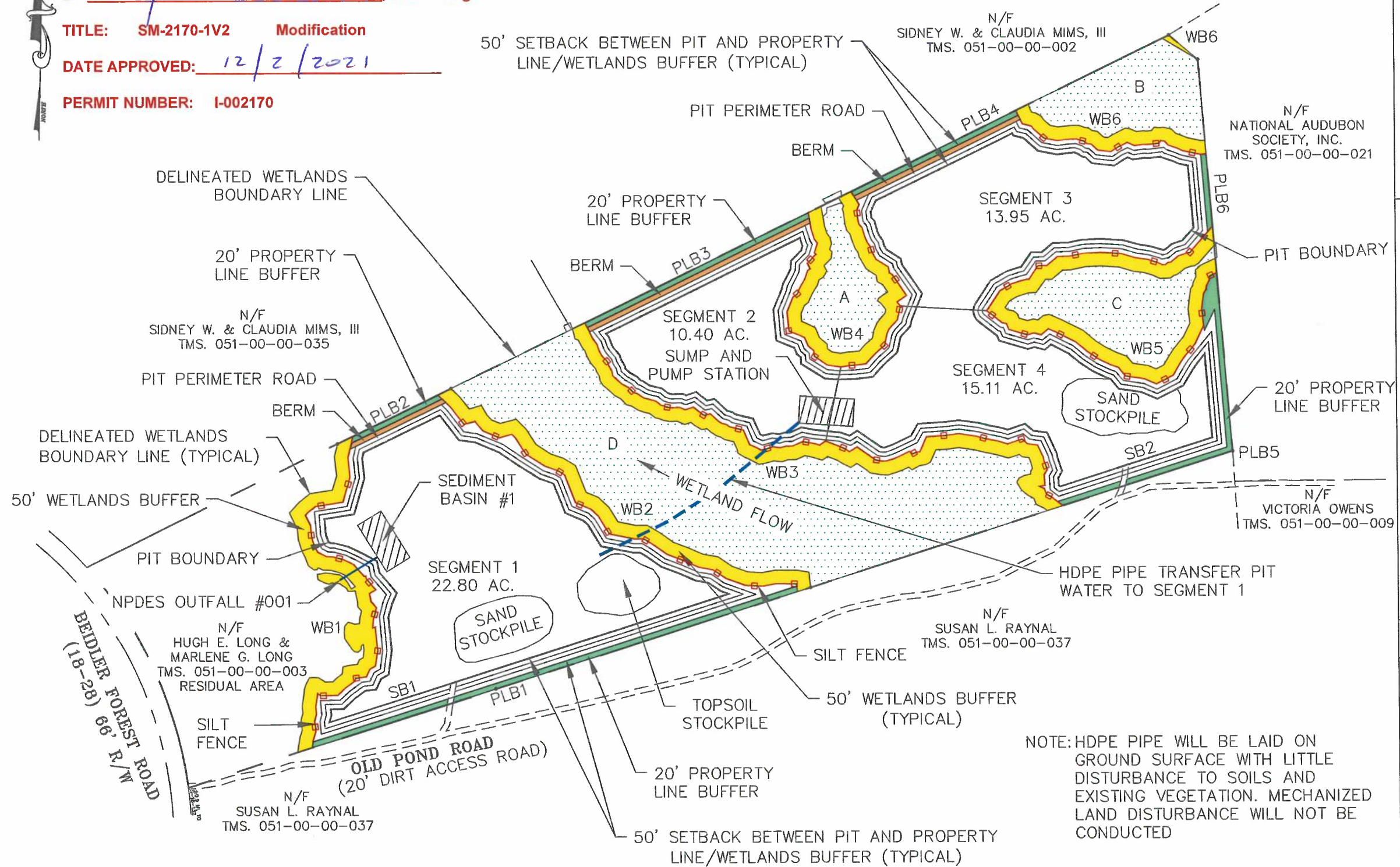

NOTE: HDPE PIPE WILL BE LAID ON GROUND SURFACE WITH LITTLE DISTURBANCE TO SOILS AND EXISTING VEGETATION. MECHANIZED LAND DISTURBANCE WILL NOT BE CONDUCTED

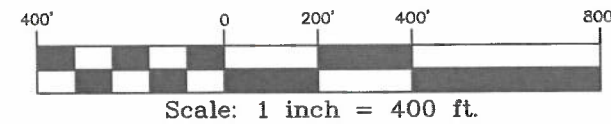

Kennedy Consulting Services, LLC  
 Craig Kennedy, P.G.  
**KCS**  
 Office:  
 403 Seaside Court  
 Lexington, SC 29072  
 P.O. Box 364 Irmo, SC 29063  
 Tel. (803) 399-1133  
 Cell (803) 960-2562  
 craigkennedy.KCS@gmail.com

**DLI Plantation Egeria Mine**  
**Mine Map**  
 Prepared for  
**Dorchester Logistics, Inc.**  
**Dorchester County, South Carolina**

| No.                    | Revision                       | Date             | By           |
|------------------------|--------------------------------|------------------|--------------|
| 1                      | ADD BERMS ON NORTH BOUNDARY    | 3/1/21           | RCK          |
| 2                      | REMOVE SED BASIN; ADD PIPELINE | 3/1/21           | RCK          |
| Project No. KCS 20-132 |                                | Date: 7-20-20    | Drawn by: BC |
| Approved by: RCK       |                                | Sheet No. 1 of 2 |              |

